

WD_BLACK™

HOW TO INSTALL A NEW M.2 SSD INTO YOUR PS5® SLIM

WHAT YOU NEED TO BEGIN

- Your officially licensed WD_BLACK™ SN850P SSD
- Well-lit room
- Table or secure flat surface
- #1 Philips or cross-head screwdriver
- Anti-static mat [optional]
- Small flashlight [optional]



STEP 1

TURN OFF YOUR CONSOLE

- Remove all cables and devices connected to your console
- Allow your console to cool down
- Place your console on a flat surface with a clean protective covering [or an anti-static mat if you have one]
- Position the console with the PS logo facing down and the back of the console facing you

STEP 2

REMOVE THE CONSOLE COVER

- Slightly lift the triangle cover away from the console to detach its clips and remove it

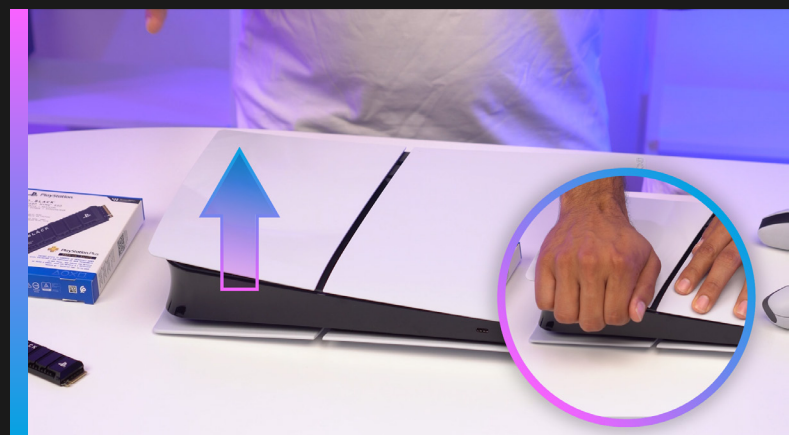

STEP_3

REMOVE EXPANSION SLOT COVER

- Locate the rectangular expansion slot cover
- Remove the screw, and then remove the cover

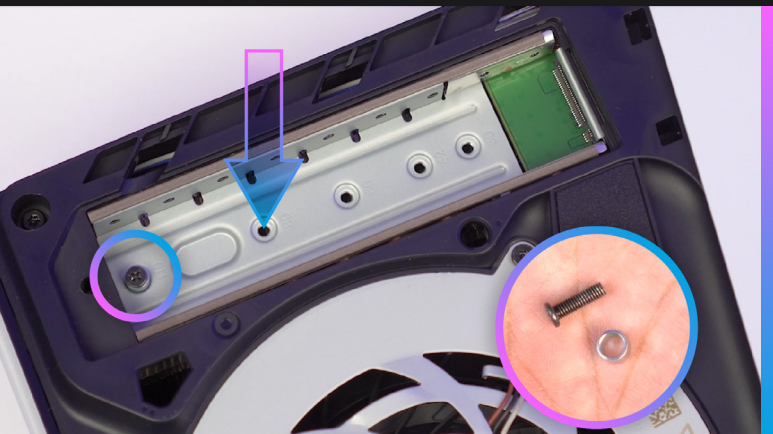

STEP_4

REMOVE M.2 SSD SCREW AND SPACER

- Remove the screw and spacer from the 110 slot
- Then put the spacer in the 80 slot

STEP_5

INSERT M.2 SSD

- Holding the edge of the WD_BLACK™ SN850P SSD, align it with the notch on the expansion connector
- Tilt the WD_BLACK™ SN850P SSD diagonally upward, and firmly insert it all the way into the expansion connector
- Carefully push the drive into the slot until you hear and feel a click
- Tilt the WD_BLACK™ SN850P SSD down and fasten it with the screw

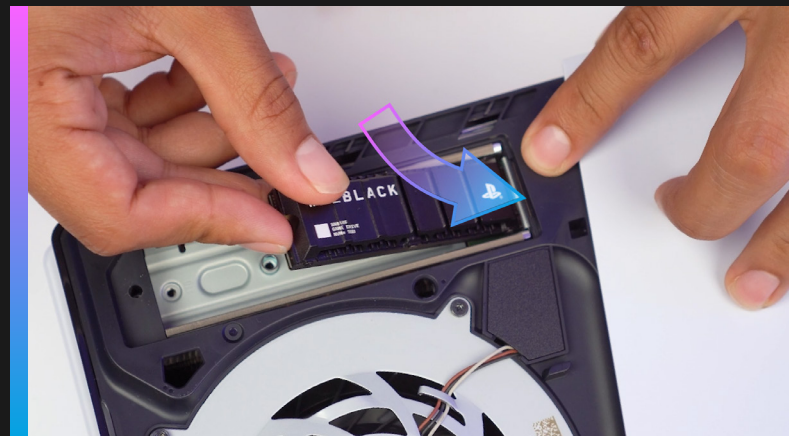

STEP_6

ATTACH EXPANSION SLOT COVER

- Attach the expansion slot cover and fasten the screw

Note: If the slot cover does not close properly, your cooling structure likely exceeds size requirements

STEP_7 REPLACE CONSOLE COVER

- Attach the triangle cover by aligning the cover's clips with the corresponding holes on the console
- Push until you hear a click, then the cover is secured



M.2 SSD Storage

To use your M.2 SSD, you need to format it.

When you format your M.2 SSD, all data on it will be deleted.

If you want to continue using your PS5 without formatting your M.2 SSD, turn off your PS5, and then remove your M.2 SSD.

Note that saved data, screenshots, and video clips can't be saved in M.2 SSD storage.

Press the  button to use the controller.

Don't Format and Turn Off PS5

Format M.2 SSD

STEP_8 RECONNECT, REFORMAT, AND PLAY!

- Reattach the feet, AC power cord, and cables
- Turn on the power
- When your PS5® console turns on, the formatting guide appears. Follow the onscreen instructions and format the M.2 SSD.
- Store and play all your favorite games from your SSD!

FAQ

Q How is an M.2 SSD different from USB extended storage on PS5® consoles?

A PS5® games can be downloaded, played, and updated directly on M.2 SSD storage. USB extended drives can only be used for storage.

Q Can I insert a SATA drive into the PS5® console?

A No, M.2 SATA SSDs aren't supported.

Q Should I remove the M.2 SSD if I send my PS5® console for repair?

A Yes. Please remove the M.2 SSD before sending it for repair.

Q Can I format part of the M.2 SSD for use on the PS5® console?

A No, the entire M.2 SSD must be formatted.

Q Can I install a heatsink on an M.2 SSD with a built-in heatsink?

A No. If your M.2 SSD has a built-in heatsink, PlayStation® doesn't recommend adding any additional heatsinks--it may reduce the effectiveness of the built-in heatsink[s].

Q Is it possible to store a part of game data on console storage and the remaining data on M.2 SSD storage?

A No. All game data for a particular game must be stored in the same place.

Q What should I do if I experience gameplay issues when I play games stored on M.2 SSD Storage?

- A**
- Press the PS button on your controller to go to the control center, and then select Downloads/Uploads. Pause any ongoing downloads.
 - If you are trying to play a game on disc, please wait for the full installation to finish.
 - If you are still having issues, PlayStation® recommends moving the game from M.2 SSD storage to console storage.

Q Will installing an M.2 SSD affect my warranty?

- A** Generally, your manufacturer's warranty coverage should not be affected provided you install an M.2 drive that meets the required specifications and you follow the installation instructions properly. Failure to do so could result in damage to your console which will not be covered under warranty. PlayStation® strongly encourages you to carefully review drive specifications prior to purchase and contact the vendor or manufacturer if you need further information. When installing the M.2 drive, you should closely reference the M.2 SSD installation instructions to help avoid any issues. Please read PlayStation®'s [complete warranty terms](#) for details of what is and isn't covered and your remedies.

Q Do PS5® consoles support Host Memory Buffer?

- A** No. Some M.2 SSD devices may support Host Memory Buffer [HMB] but they may experience slower-than-expected performance because the PS5® console does not support HMB.